



## 3M™ Speedglas™ 9100XXi FX Air Welding Helmet with 3M™ Adflo™ Powered Air Respirator

- Flip-up mechanism reveals a clear high impact grinding visor (AS/NZS1337.1)
- New upgraded Adflo is super light with rapid charge
- Required Minimum Protection Factor (RMPF) of 50
- Improved respiratory protection and comfort (AS/NZS1716)
- Extra-large viewing area with SideWindows for peripheral vision
- New True-View for colour and contrast
- Advanced TST (TIG Sensor Technology) down to industry leading 1 amp
- Two adjustable air flow settings 170/200 litres per minute
- Highest possible optical classification (1/1/1)
- Available with Standard (up to 8 hours run time) OR Heavy Duty (up to 12 hours run time) battery\*



## What's happening to your health?

What do increased clumsiness, ulcers, and flu symptoms have in common? They - and many more symptoms - might be caused by overexposure to welding fumes.

### Potential short-term health effects of certain welding fumes

- Eye, nose and throat irritation.
- Dizziness.
- Nausea.
- Headaches.
- Metal fume fever. Notably, it is more likely to occur after time away from the job (weekends, holidays, etc.)<sup>9)</sup>

### Potential long-term health effects of certain welding fumes

- Lung function abnormalities, including bronchial asthma, chronic obstructive pulmonary disease (COPD), pneumoconiosis and other pulmonary fibrosis (chronic beryllium disease, cobalt lung), and lung cancer.<sup>9)</sup>
- Larynx and urinary tract cancers.<sup>9)</sup>
- Certain fumes can lead to stomach ulcers, kidney damage, and nervous system damage.<sup>9)</sup>



## Welding fume now reclassified as 'Carcinogenic to humans'

In early 2017, welding fume was reclassified from IARC classification Group 2B (Possibly carcinogenic to humans) to Group 1 (Carcinogenic to humans). This change was primarily associated with the effects of UV exposure on the skin and eyes and also for lung cancers and limited evidence for kidney cancer from welding fume exposures.



3M™ Versaflo™ Face Shield M-107 with 3M™ Adflo™ PAPR

- Woodworking
- Painting
- Grinding
- Manufacturing
- Cutting
- Cleaning

Complies with AS/NZS 1716 (respiratory) and AS/NZS1337.1 (high impact face protection) standards. Scratch resistant lens, flame resistant face seal.

"Step up to Speedglas"

Part No	Description
<a href="#">54 77 26</a>	3M Speedglas Welding Helmet 9100XXi FX Air with Standard Adflo™ powered air respirator.
<a href="#">547726HD</a>	3M Speedglas Welding Helmet 9100XXi FX Air with Heavy Duty Adflo powered air respirator.



Open Monday to Friday 8am-5pm **APRIL 2019**  
Saturday 8am-12pm (except public holiday long weekends)

\*All prices listed are subject to change without notice, gst not included unless stated otherwise

Ph 0800 272 935 sales@arcweld.co.nz www.arcweld.co.nz  
9 Bandon Street, Frankton, Hamilton.



Spare parts & accessories for 3M™ Speedglas™ Welding Helmet 9100 FX Air

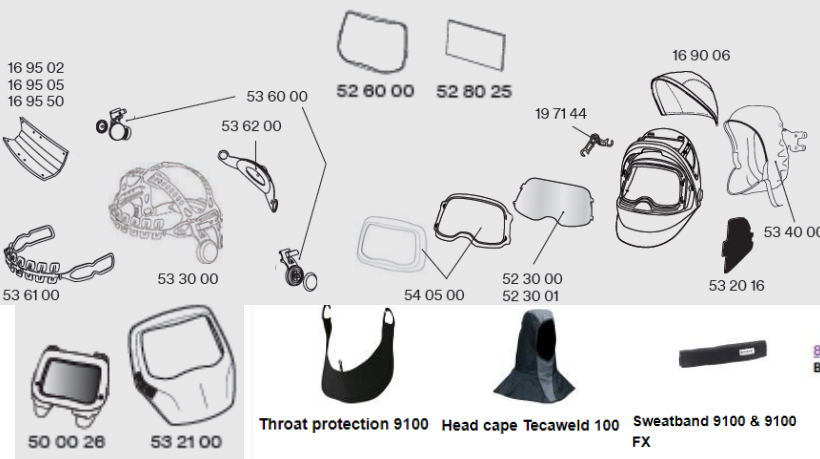

Throat protection 9100 169010  
 Head cape Tecaweld 100 169100  
 Sweatband 9100 & 9100 FX 169505



Argyle Performance Workwear is ISO 9001 and ISO 14001 Approved



**ARGYLE EXTREME TTMC-W17 SHERPA LINED JACKET**

Code 47HLTTMC-W / Colour Orange/Black / Sizes XS-4XL, 6XL & 8XL



**ARGYLE EXTREME HI VIS RAINTROUSERS**

Code TNSPO / Colours Orange/Black & Yellow/Black / Sizes S-4XL, 6XL & 8XL



**ARGYLE STAMINA DAY/NIGHT JACKET**  
Premium Weight

Code 46NJKT / Colours Orange/Navy & Yellow/Navy in sizes S-4XL, 6XL & 8XL / Colour Yellow/Black in sizes XS-4XL, 6XL & 8XL

**ARGYLE EXTREME Bib Overtrouser**

Code BN0PO / Colour Orange/Black / Sizes S-4XL & 6XL

**ARGYLE STAMINA BIB OVERTROUSER**  
Premium Weight

Code BIWPO / Colours Orange & Yellow  
Sizes S-4XL, 6XL & 8XL



**ARGYLE STAMINA TTMC-W17 COMBO**  
Premium Weight 5-in-1 Jacket and Vest

Code JTP5N1 / Colour Orange / Sizes XS-4XL, 6XL & 8XL

**ARGYLE STAMINA DAY/NIGHT VEST**  
Premium Weight

Code V17 / Colours Orange/Navy, Yellow/Navy  
Sizes XS-4XL, 6XL & 8XL



Open Monday to Friday 8am-5pm  
 Saturday 8am-12pm (except public holiday long weekends)

APRIL 2019

\*All prices listed are subject to change without notice, gst not included unless stated otherwise

Ph 0800 272 935 sales@arcweld.co.nz www.arcweld.co.nz  
 9 Bandon Street, Frankton, Hamilton.